



Hanover House, SE18

Offers Over £250,000

- Chain Free
- Close To Transport Links
- Excellent Location
- Leasehold
- One Bedroom
- Recently Refurbished
- Second Floor



Offered to the market chain free, this beautiful one bedroom apartment is located just off the up and coming Plumstead High Street.

This apartment has recently been refurbished to an outstanding standard and is set on the second floor of this modern development. The property comprises of a large open plan kitchen and reception room, a beautiful tiled bathroom and one bedroom.

From a location perspective, the property could not be better situated, with a superb range of amenities on your doorstep. Plumstead and Woolwich are part of South East London's massive regeneration project, with Woolwich town centre almost unrecognisable compared to just a few years ago. The exciting new Cross Rail project is also due for completion in 2022.

Contact Kallars to arrange your viewing today.

Personal Interests Dec: In accordance with section 21 of Estate Agents Act 1979, we declare there is a personal interest in the property, the vendor of the property is an employee of this Estate Agent.



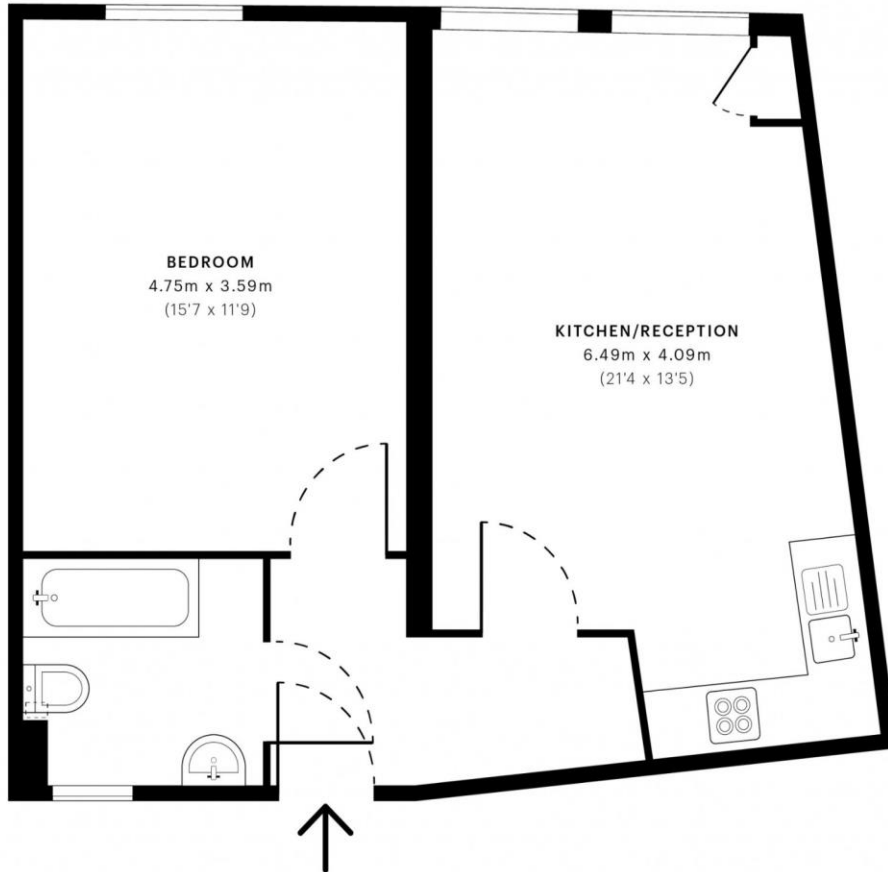

— Second Floor

GROSS INTERNAL AREA (GIA)
The footprint of the property
50.96 sqm / 548.53 sqft

NET INTERNAL AREA (NIA)
Excludes walls and external features
Includes washrooms, restricted head height
48.84 sqm / 525.71 sqft

EXTERNAL STRUCTURAL FEATURES
Balconies, terraces, verandas etc.
0.00 sqm / 0.00 sqft

RESTRICTED HEAD HEIGHT
Limited use area under 1.5 m
0.03 sqm / 0.32 sqft



Spec Verified floor plans are produced in accordance with Royal Institution of Chartered Surveyors' Property Measurement Standards. Plots and gardens are illustrative only and excluded from all area calculations. Due to rounding, numbers may not add up precisely. All measurements shown for the individual room lengths and widths are the maximum points of measurements captured in the scan.

IPMS 3B RESIDENTIAL 51.78 sqm / 557.36 sqft
IPMS 3C RESIDENTIAL 49.79 sqm / 535.94 sqft

SPEC ID 621643ec46f6d90de8ef7c10

